



Note: Lots are rented or sold by the owners listed. Please contact owners directly.

Note: This list is not affiliated with Rolling Ridge Condominium Association

To Reach RR Condo Association - E-Mail: rrrvcondoassoc@gmail.com

Lots for Rent

Updates as they are available

Send email to:

Nick Boersma - Lot 90

rrrvlotinfo@gmail.com

231-883-4963

Activities email: rrrvsocial@gmail.com

Go to our website for photos and lot details.

www.rollingridgervresort.com

Yellow Highlighted lines are rented for Winter Season 2022/23. Check for other dates available.

Lots for Rent

Lot #	Electric	Shed	W&D	Frig	Pavers	Rented or Available	Price	Owner	Phone	E-mail
6	20/30/50	X			X	R: Till 11-1-2023	Rented	Rudd, Denny	585-752-1695	camperden38@gmail.com
7	2B Park Model with cabin			X	X		Call for Rates	Ellis, Marie	304-208-6041	mariescharmschool@gmail.com
11	20/30/50	X			X	A: 5-1-24 to 11-1-24	Call for Rates	Dresch, Steve	518-857-6421	teech4538@aol.com
21	20/30/50	X			X	R: Rented Long Term 3-15-24	Call for Rates	Demartino, Janice	407-466-4649	jandemartino@icloud.com
26	Park Model	X			X	R: Till 4-1-25, then available	Rented	Solis, Carlos	352-988-3437	solisbravomusic@gmail.com
29	20/30/50	X	X		X	R: Till 6-2025	Rented	Lowetz, Al	616-862-8179	alowetz@aol.com
33	Park Model	X	X	X	X	A: 5-15-24, Long term	Call for Rates	Entler, Kathy	352-636-5419	kathyentler612@gmail.com
45	20/30/50	X	X	X	X	R: Rented long term	Rented	Haines, Brad	574-536-4966	bradlelahaines@gmail.com
58	20/30/50				X	A: 3-1-24	Call for Rates	Lahmers, Marcia	419-571-3093	marcialahmers1979@gmail.com
59	23/30/50	X			X	R: Long Term	Rented	Pool, Alan	352-360-5722	alanpool53@icloud.com
63	20/30/50	X	X		X	R: 10-1-23 to 10-1-24	Rented	Sinisi, Dave	814-889-8438	dpsinisi@aol.com
75	20/30/50				X	R: Till 4-1-25	Rented	Cenotti, Daniel	774-722-0930	dans1plumbing@gmail.com
76	20/30/50				X	A: 4-1-24 long term	Call for Rates	Kerns, Nicolette	860-989-3550	kernsn@att.net
77	20/30/50	X	X		X	A: Now, R: 10-1-24 to 4-1-25	Call for Rates	Kerns, Nicolette	860-989-3550	kernsn@att.net
79	20/30/50				X	A: April 1 long term	Call for Rates	Montalvo, Andrea	352-346-2865	faithranch5@gmail.com
82	20/30/50				X	R: Long term	Rented	Haines, Brad	574-536-4966	bradlelahaines@gmail.com
86	30/50	X	X	X	X	R: Till 4-30-25	Rented	Eastman, Bill	269-838-4064	eastmanwilliam304@gmail.com
112	20/30/50	X			X	A: long term 4-1-24	Call for Rates	Pool, Alan	352-360-5722	alanpool53@icloud.com
120	50	X	X	X	X	A: 5-1-24 to 10-31-24	Call for Rates	Haas, Thomas	513-267-5239	haas.thomas3@gmail.com
121	50	X	X		X	A: Available 7-1-24	Call for Rates	Haas, Thomas	513-267-5239	haas.thomas3@gmail.com
135	50	X	X		X	R: Till 3-14-25	Rented	Lowetz, Al	616-862-8179	alowetz@aol.com
137	20/30/50	X			X	R: 10-1-24 to 9-30-25	Rented	Worzalla, Dave	920-716-1635	daveworz71@yahoo.com
								Pagel, Maureen	920-716-8080	pagelm32867@gmail.com
140	20/50	X				R: 4-15-24 to 10-30-24	Call for Rates	Morris, Shannon	352-988-0252	happyflatsinc@gmail.com
141	50	X	X	X	X	R: Till 3-21-25	Rented	Lowetz, Al	616-862-8179	alowetz@aol.com
142	20/30/50	X	X	X	X	A: 4-1-24 to 10-1-24	Call for Rates	Stickles, Lionel	410-241-4447	lestickleslll@gmail.com
143	D. Trailer	X			X	A: 4-9-23 to 12-31-23	Call for Rates	Samson, Blair	902-227-7410	rebmun1@outlook.com
147	50	X	X		X	A: Available 12-01-2024	Call for rates	Lowetz, Al	616-862-8179	alowetz@aol.com
148	20/30/50				X	A: 4-1-24 to 10-15-24	Call for Rates	Karwacki, Steve	630-921-4042	stevekarwacki@gmail.com
149	20/30/50				X	R:	Rented	Stickles, Lionel	410-241-4447	lestickleslll@gmail.com
151	20/30/50	X	X		X	R: Till 10-1-25	Rented	Polly, Tracy	352-267-4268	ttobin24@hotmail.com
154	50	X	X	X	X	R: Till 5-31-25	Rented	Lowetz, Al	616-862-8179	alowetz@aol.com
155	50				X	A: 4-1-24 to 11-1-24	Call for Rates	Windass, Ian	613-561-0631	ianwindass@yahoo.ca



Note: Lots are rented or sold by the owners listed. Please contact owners directly.

Note: This list is not affiliated with Rolling Ridge Condominium Association

To Reach RR Condo Association - E-Mail: rrrvcondoassoc@gmail.com

Lots for Sale

Updates as they are available.

Send Email to:

Nick Boersma - Lot 90

rrrvlotinfo@gmail.com

231-883-4963

Activities email: rrrvsocial@gmail.com

Go to our website for photos and lot details.

www.rollingridgervresort.com

Lots for Sale

Lot #	Electric	Shed	W&D	Frig	Pavers	Availability	Price	Owner	Phone	E-mail
18	Park Model	X	X		X	Pending	\$ 165,000.00	Pierce, Michelle	480-223-3483	mlpierce3483@gmail.com
31	Park Model	X	X	X	X	For Immediate Sale	Call for Pricing	Parsons, Sharon	724-710-5780	sharonparsons1966@yahoo.com
33	Park Model	X	X		X	Currently Rented	Call for Pricing	Entler, David	352-636-5419	kathyentler612@gmail.com
59	20/30/50	X			X	Currently Rented	Call for Pricing	Pool, Alan	352-360-5722	alanpool53@icloud.com
127	20/30/50	X			X	Lot and Keystone Outback 2023 328RL, 12 x 16 shed, etc.	Call for Pricing	Kurland, Roger	561-702-1096	thekurland@mindspring.com
75	20/30/50				X	Corner lot	Call for Pricing	Cenotti, Dan	774-772-0930	dan1plumbing@gmail.com
95	20/30/50	X	X	X	X	Lot for Sale with custom RV 2015 Majestic New Horizon Model MF40RL4SS	Call for Pricing	Bondurant, Adalin	208-255-6122	adalin.bondurant@gmail.com



Note: Lots are rented or sold by the owners listed. Please contact owners directly.

Note: This list is not affiliated with Rolling Ridge Condominium Association

To Reach RR Condo Association - E-Mail: rrrvcondoassoc@gmail.com

RV's & Trailers for Sale

Updates as they are available.

Send Email to:

Nick Boersma - Lot 90

rrrvrлотinfo@gmail.com

231-883-4963

Activities email: rrrvsocial@gmail.com

Go to our website for photos and lot details.

www.rollingridgervresort.com

RV's for Sale

RV	Price	Owner	Phone	E-mail
2015 Majestic New Horizon Model MF40RL4SS	Contact owner	Bondurant, Adalin	208-255-6122	adalin.bondurant@gmail.com
2006 Winnebago Adventure 38'	Contact owner	Bertch, Dave	585-738-4320	



20285 US Highway 27 - Clermont, FL 34715

Rolling Ridge Site Map

GPS: 28.640679, -81.79813

Lot information: 231-883-4963

Email: rrvrlotinfo@gmail.com

Pet Areas 

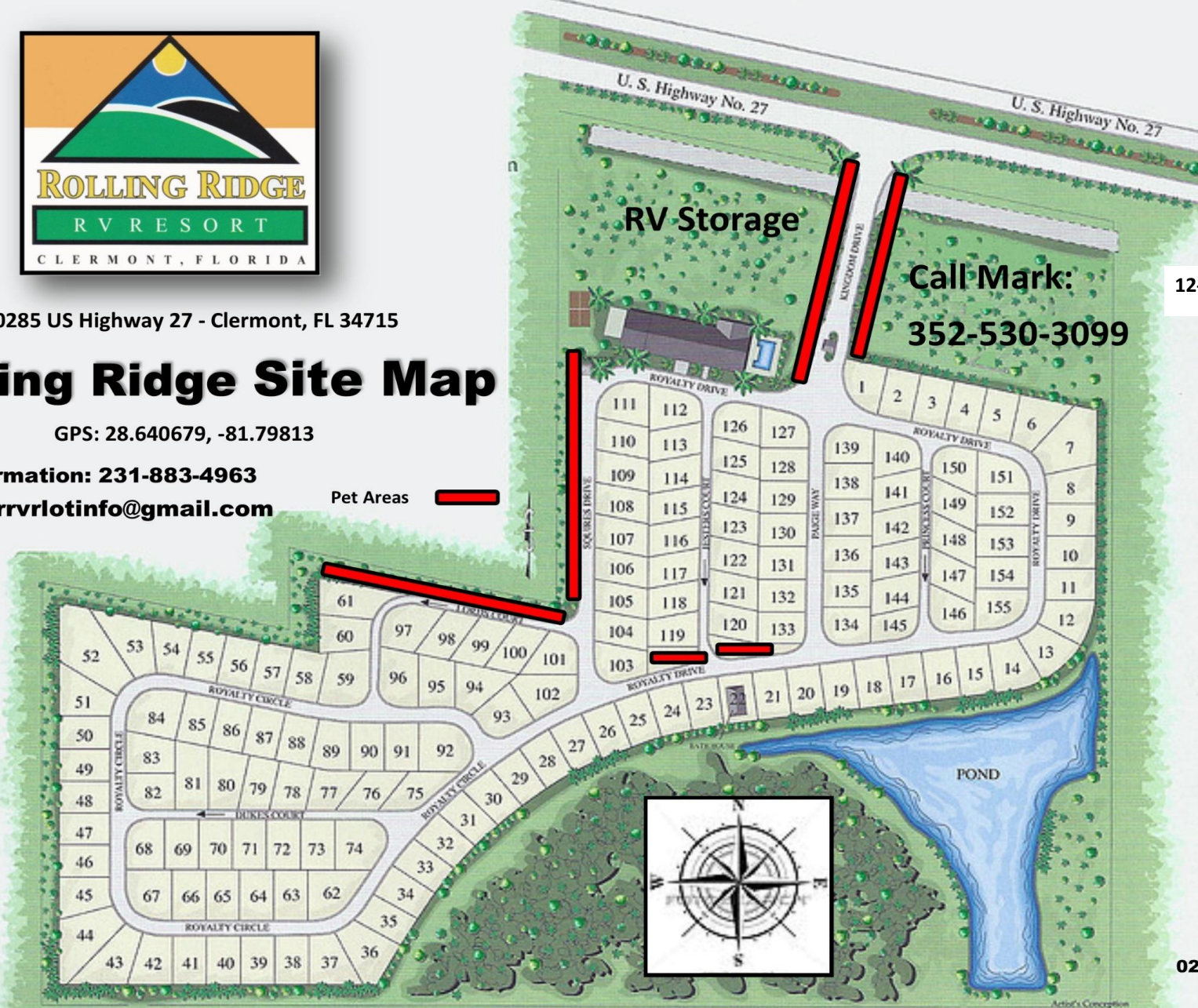

Call Mark:
352-530-3099

12-26-2023

02-01-2020

